



# Capture Visualization

## Specification Sheet



**Capture Visualization** is a 2D / 3D lighting design software using 3D studio graphics. Unlike other Cad based design Software's, you don't need to learn Cad. Capture is a drag and drop easy to learn software. Simply find your fixture or object, drag it into the workspace and modify to your specifications. Easily place objects with X Y Z views.

### 2D designs and Plots

Create your Stage or venue layouts and lighting Plots, create fixture patch using real life fixture modes. Transfer patch over to lighting consoles using CIPF.

### 3D View and Graphics

Bring your design to life with Captures latest real texture 3D engine. The beauty of Capture is how fast it renders to 3D. Where other software's can take 10-30 minutes to Render, Capture converts to LIVE view in seconds. Capture libraries use photometric data to show difference in light outputs.

### Licensing & Versions

Capture does not have a yearly subscription, when you buy a Capture license it belongs to you for as long as your computer supports it. Capture releases a new version of Capture software every year that takes advantage of the power provided from newer computing power. Newer Versions upgrades are available for purchase at a reduced price. Download full licensing PDF.

### Editions

There are 4 Editions available to get started with Capture. All editions unlock key features and allow you to save your work. You can start with smaller editions and upgrade when needed to own the Full Version of Capture.

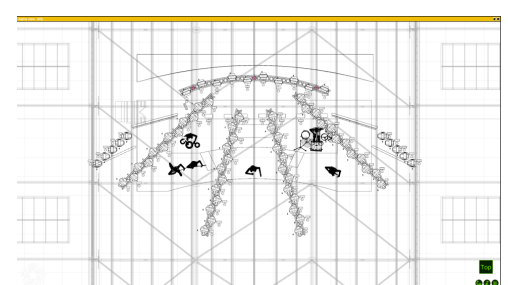
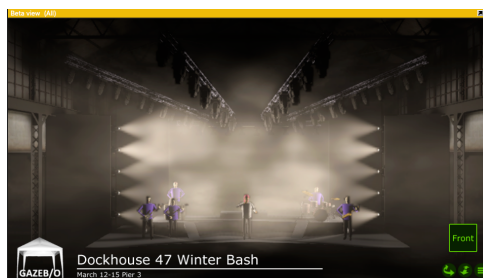
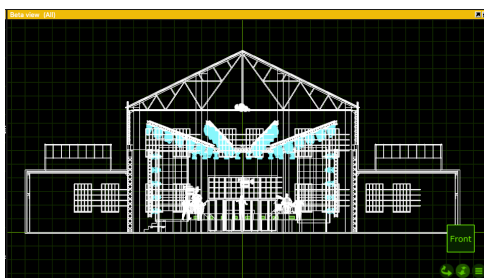
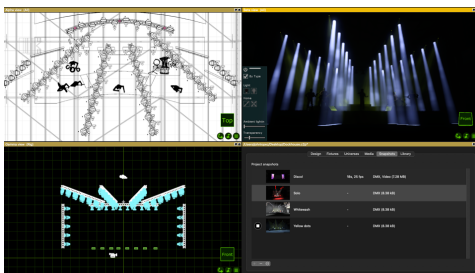
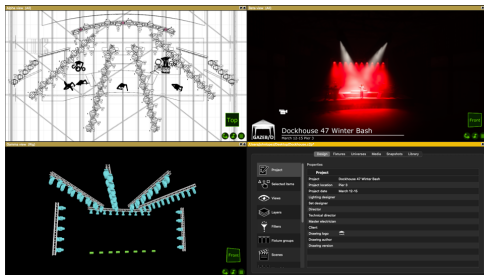



### Capture License Editions

There are 4 key components unlocked per Edition Plus, the ability to Save your work.

- Quantity of DMX Universes
- Local Video
- Streaming Video feed
- Laser Feeds

Capture Solo – Unlocks 1 of each  
 Capture Duet – Unlocks 2 of each  
 Capture Quartet – Unlocks 4 of each  
 Capture Symphony - Is Unlimited

### How to purchase

- No physical product shipped
- Digital licenses sent via e-mail.
- Capture available through your preferred authorized Elation Dealer.

### Computer requirements

Mac OS: Mac OS 10.15 with Metal  
 Windows: 10–11 64bit with DirectX 11.1

Go Mobile with ~ iOS – iPad or iPhone App

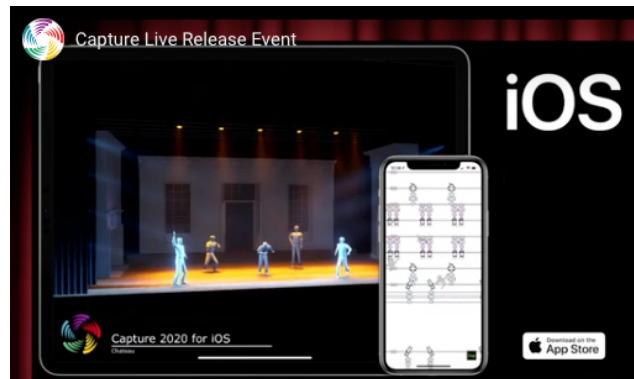

### Library requests

[library@capture.se](mailto:library@capture.se)

## CAPTURE 2022 Editions

Order No.	Capture Editions	Universes	Local Video	Streaming Video	Laser Feeds
CAP651	SOLO	1	1	1	1
CAP762	DUET	2	2	2	2
CAP873	QUARTET	4	4	4	4
CAP984	SYMPHONY	unlimited	unlimited	unlimited	unlimited

Order No.	Edition Upgrade
CAP010	Solo → Duet
CAP020	Solo → Quartet
CAP030	Solo → Symphony
CAP040	Duet → Quartet
CAP050	Duet → Quartet
CAP060	Quartet → Symphony

Order No.	Version Upgrade
CAP110	SOLO
CAP120	DUET
CAP130	QUARTET
CAP150	SYMPHONY

\*Contact your Authorized Elation Dealer to purchase





# CAPTURE SPECIFICATIONS

<p><b>Model File Import Formats</b></p> <ul style="list-style-type: none"> <li>○ glTF</li> <li>○ DWG/DXF</li> <li>○ MVR</li> <li>○ Cinema 4D</li> <li>○ SketchUp</li> <li>○ OBJ</li> <li>○ 3DS</li> </ul>
<p><b>Model File Export formats</b></p> <ul style="list-style-type: none"> <li>○ DWG/DXF</li> <li>○ glTF</li> <li>○ MVR</li> </ul>
<p><b>Data File Import Formats</b></p> <ul style="list-style-type: none"> <li>○ CSV</li> <li>○ CSV, ETC EOS flavour</li> </ul>
<p><b>Data File Export Formats</b></p> <ul style="list-style-type: none"> <li>○ CSV</li> <li>○ XML for Hog</li> <li>○ XML for grandMA 2</li> </ul>
<p><b>Video Capture Devices</b></p> <ul style="list-style-type: none"> <li>○ Any with Windows (Media Foundation) drivers</li> <li>○ Any with macOS drivers</li> </ul>
<p><b>USB Devices</b></p> <ul style="list-style-type: none"> <li>○ 3Dconnexion Space Mouse</li> </ul>

<p><b>Ethernet DMX Protocol</b></p> <ul style="list-style-type: none"> <li>○ Art-Net</li> <li>○ CITP</li> <li>○ Compulite VC</li> <li>○ High End Hog visualizer connectivity</li> <li>○ ETC Net 2</li> <li>○ MA-Net2 (Windows only, MA software version 2.9+)</li> <li>○ MA-Net3 (grandMA3 viz-key)</li> <li>○ sACN</li> </ul>
<p><b>USB DMX Devices</b></p> <ul style="list-style-type: none"> <li>○ EntTec DMX USB Pro</li> <li>○ EntTec DMX USB Pro Mk2</li> </ul>
<p><b>Streaming Video Media Protocols</b></p> <ul style="list-style-type: none"> <li>○ NewTek NDI</li> <li>○ CITP/MSEX</li> <li>○ Green Hippo HMap 3</li> </ul>
<p><b>Streaming Laser Media Protocols</b></p> <ul style="list-style-type: none"> <li>○ CITP/CAEX</li> <li>○ LaserAnimation</li> <li>○ Pangolin Beyo</li> </ul>
<p><b>Motion Tracking Protocols</b></p> <ul style="list-style-type: none"> <li>○ Blacktrax RTTrP</li> <li>○ Kinesys K2</li> <li>○ PosiStageNet</li> </ul>

